

Dry Erase Markerboard Care & Cleaning Instructions

- If your new board has a label on the surface telling you to remove the protective film, follow the instructions on the label and remove the film at this time.
- Use Best-Rite® Green Erase™ Eco-Friendly Whiteboard Cleaner to remove any adhesive residue left on the board surface. See back page for ordering information.
- For best results, use Best-Rite® Rite-On™ Markers on your new board. See back page for ordering information on markerboard accessories.
- Do not allow dry erase marker ink to remain on the board for several days without erasing.
- Clean your dry erase board weekly to prevent marker color build up. Use Green Erase™ with a clean, soft cloth to keep your board surface looking new.
- Use a dry erase marker to color over areas that are hard to clean. Then erase. The solvent in the ink will frequently clean the soiled area.
- Alternative dry erase board cleaners:
 - Soap and water
 - Alcohol
 - Glass cleaners
 - Ceramic stove top cleaners
 - Non-abrasive household cleaners





Balt & Best-Rite are brand divisions of MooreCo, Inc.
 2885 Lorraine Ave
 Temple, TX 76501
 p: 800.749.2258
 f: 800.697.6258
www.moorecoinc.com



See product video online!
youtube.com/moorecoinc



Recognized for safer chemistry
 by the EPA.
www.epa.gov/dfe



Green Erase™ Eco-Friendly Whiteboard Cleaner

- » New Green Erase™ eco-friendly multi-purpose cleaner is made from readily biodegradable and renewable ingredients.
- » Easily cleans marker from any dry erase surface without streaking or ghosting.
- » Recognized for Safer Chemistry by the EPA.
- » Made in the USA. TAA compliant.

Part No.	Description	Weight
■ 580*	1 quart	4 lbs

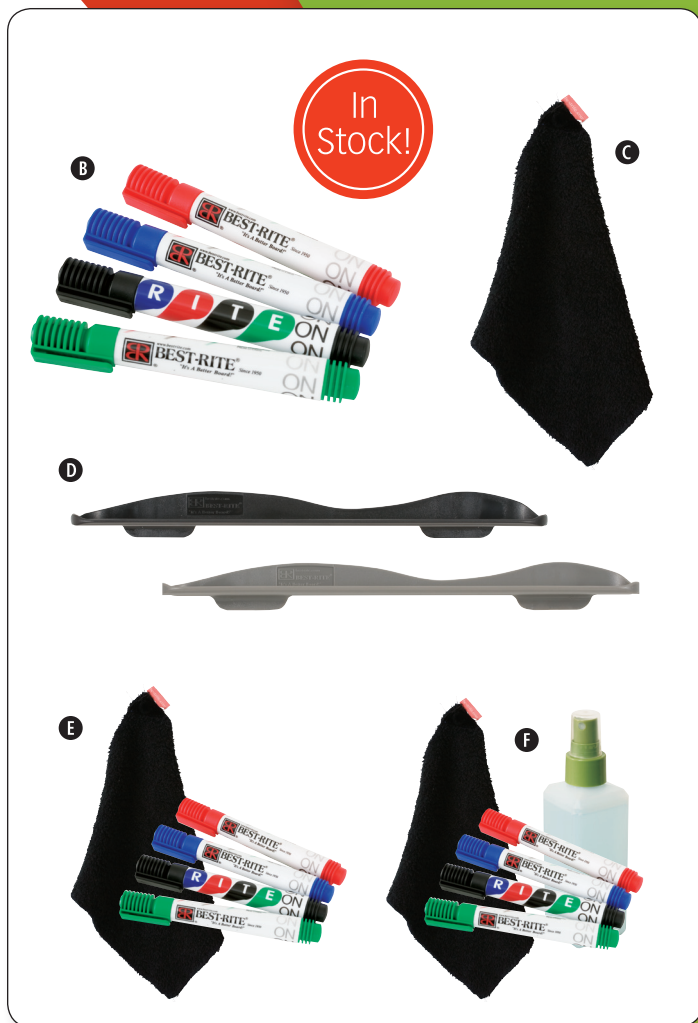

Markerboard Accessories

- B. Rite-On™ Markers** - Set of four markers specially engineered for optimum results with Best-Rite® dry erase surfaces.
- C. Magnetic Eraser Cloth** - Black cloth features a magnet sewn into one corner to attach to any magnetic surface. Erases cleanly with no ghosting.
- D. Magnetic Q-Tray** - Durable plastic tray attaches to any magnetic surface to hold markers and erasers.
- E. Dry Erase Board Accessory Kit** - Four packs of Rite-On™ Markers and two Magnetic Eraser Cloths.
- F. Multimedia Board Accessory Kit** - Six packs of Rite-On™ Markers, two Magnetic Eraser Cloths, and a spray bottle for board cleaner.

Part No.	Description	Weight	
■ 554E4*	Set of 4	¼ lb	
Part No.	Dimensions	Weight	
■ 555*	10"H x 10"W	¼ lb	
Part No.	Color	Dimensions	Weight
■ MT-16*	Black	1 ¼"H x 16 ¼"W	½ lb
■ MT-16G*	Gray	1 ¼"H x 16 ¼"W	½ lb
Part No.	Description	Weight	
■ 556*	4 packs of markers / 2 eraser cloths	2 lbs	
Part No.	Description	Weight	
■ 567*	6 packs of markers / 2 eraser cloths / spray bottle	2 lbs	